

Series N600/600

Spring Rewind Dual Hose Reels To handle dual 1/4" through 3/4" I.D. hose.

Dual-hose spring rewind reels are available in two frame configurations. The N series has a narrow frame and compact mounting base. The rollformed channel frame for heavy-duty applications is available in the 600 series, and must be specified. (Delete prefix N for Rollformed Channel Frame.)

Series N600 and 600 reels have two swivel joint inlets and two outlet risers to handle two equal lengths of hose. Hoses can be different diameters, in which case the larger hose diameter determines the capacity of the reel.

Reels are available for use with oxygen/acetylene.
See Hannay Reels Welding Catalog H-9422-W.

Rewind:

A heavy-duty spring motor provides self-contained rewind power. A non-sparking ratchet assembly locks the reel when the desired length of hose has been payed out. A pull on the hose unlocks the reel and the spring motor retracts the hose. A declutching arbor is provided to prevent damage from reverse winding.

Inlets:

Standard inlets are 90° balanced pressure swivel joints with 1/2" female NPT threads. Where flow rates are critical specify full flow swivel joints and advise seal compatibility (overall Dimension may change).

Outlets:

Standard outlets are 1/2" female NPT threads.

Other sizes and/or threads can be furnished and must be specified.

Operating Pressures & Temperatures:

These reels operate at pressures to 3000 psi (207 bar) and handle product temperatures from -20° F to +225° F (-29°C to +107°C).

Reels to operate at other pressures and temperatures can be furnished at extra cost.

Rollers:

All models are supplied with a 4-way roller assembly. Roller position must be specified. (See Ordering Guide & Accessory Catalog.)

Hose Stop:

A hose stop should be used to prevent damage to rollers and nozzles and to permit adjustment of free hose length. (See Ordering Guide & Accessory Catalog.)

Finish: Refer to page 4.

**For Constant Tension Applications
Consult Factory.**



For:

- Hydraulics
- Air/Water
- Paint Spraying

Series N600

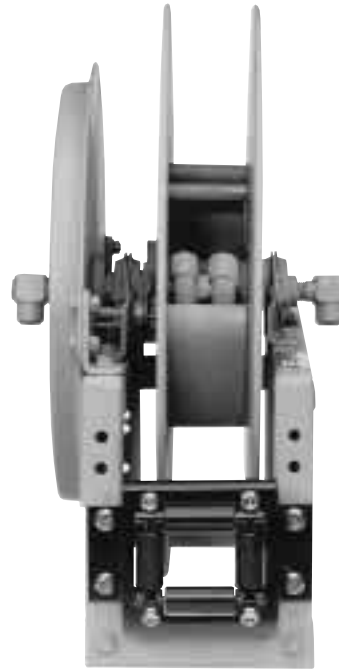

Series 600

Standard Configuration Shown

Dimensions and capacities

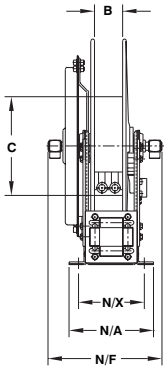

Series N600 Narrow Frame

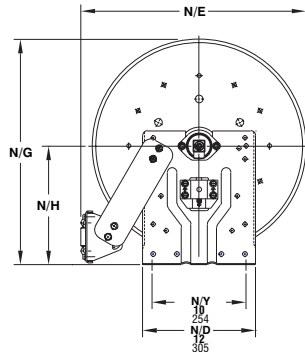

Series 600 Rollformed Channel Frame

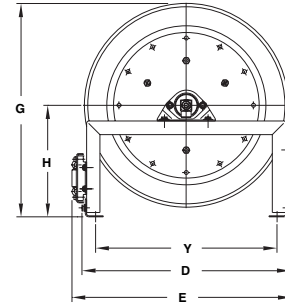
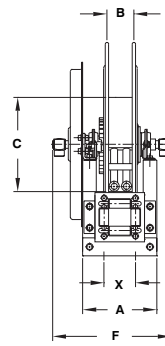

Roller Positions Available

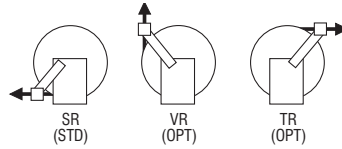

BE SURE TO CHECK DIMENSIONS AND WEIGHTS PRIOR TO ORDERING.

To receive a detailed parts breakdown drawing for Series N600, request ISO 80, for Series 600, request ISO 8.

Hose Capacity of Reel					Model Number	Reel Dimensions															Approx. Weight		Roller Assy Supplied on Standard Models	
feet m.						inches mm.															lb.	kg.		
I.D. (in)	1/4"	3/8"	1/2"	3/4"	Delete prefix N for Rollformed Channel Frame	A	N/A	B	C	D	E	N/E	F	N/F	G	N/G	H	N/H	N/X	X	Y	NET	SHIP	
I.D. (mm)	6	10	13	19		x, y indicate mounting holes. See page 2.																		
O.D. (in)	5/8"	3/4"	7/8"	1 1/2"		O.D. (mm)	16	19	22	33														
2/35	2/35	2/20	-		N615-19-20C	8.25	9	3	10.5	18	19.5	20.75	13.0	11.75	19.75	20	10.38	10.62	7	3.5	15	63	78	N203
2/11	2/11	2/6	-			210	229	76	267	457	495	527	330	298	502	508	264	270	178	89	381	28.6	35.4	
2/50	2/50	2/25	-		N617-19-20J	10.25	11	5	10.5	18	19.5	20.75	15.0	13.75	19.75	20	10.38	10.62	9	5.5	15	66	86	N205
2/15	2/15	2/8	-			260	279	127	267	457	495	527	381	349	502	508	264	270	229	140	381	29.9	39	
2/65	2/60	2/30	-		N615-23-24B	8.25	9	3	10.5	23.25	24.38	23.75	13.0	11.75	23.88	24	12.5	12.62	7	3.5	20.25	87	104	N203
2/20	2/18	2/9	-			210	229	76	267	591	619	603	330	298	607	610	318	321	178	89	514	39.5	47.2	
2/75	2/75	2/50	-		N617-25-26B	10.25	11	5	15.5	25	26.12	25.25	15.0	13.75	25.88	26	13.5	13.62	9	5.5	22	93	128	N205
2/23	2/23	2/15	-			260	279	127	394	635	663	641	381	349	657	660	343	346	229	140	559	42.2	58.1	
2/100	2/85	-	-		N617-25-26A	10.25	11	5	15.5	25	26.12	25.25	15.75	14.5	25.88	26	13.5	13.62	9	5.5	22	120	155	N205
2/31	2/26	-	-			260	279	127	394	635	663	641	400	368	657	660	343	346	229	140	559	54.4	70.3	
-	-	2/100	2/50		† 618-30-31A	11.25	-	6	15.5	28.5	29.62	-	21.75	-	31.38	-	17	-	-	6.5	25.5	130	165	R206
-	-	2/31	2/15			286	-	152	394	724	752	-	552	-	797	-	432	-	-	165	648	59	74.8	

Specifications subject to change.

Notes:

1. Reel models and capacities shown are for standard drag applications; for vertical lift or constant tension applications consult factory.

2. Many other sizes, from standard components, available on request.

† Standard inlets on this model reel are 90° swivel joints with 1" NPT threads, standard outlets are 3/4" female NPT threads.