

ACCESSORIES

Direct Drive



Cat Pumps® offers a wide range of quality accessories. Adhering to the same exacting standards as our pumps, all accessories are performance-tested and designed to match each pump's unique specifications. By demanding Cat Pumps products, you receive the best value and lowest life-cost over the life of the system.

To ensure the very best system life-cycle, Cat Pumps offers bell housing/flexible coupling assemblies, motorized flange mount units, gearbox pumps, hollow shafted pumps, lubricants and keys to meet your direct drive installation needs. Hydraulic and pneumatic drive options are available, but not shown. Contact Cat Pumps for information. Whatever the need, Cat Pumps has a selection of proven accessories to compliment your pump investment.

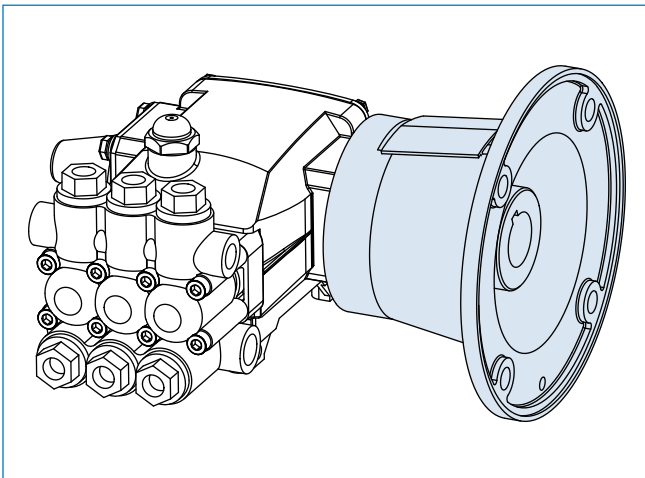

Bell Housing/Flexible Coupling

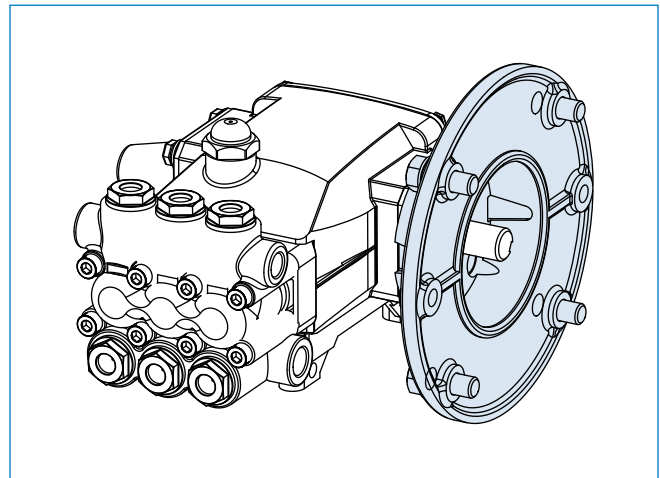

Motorized Flange Mount

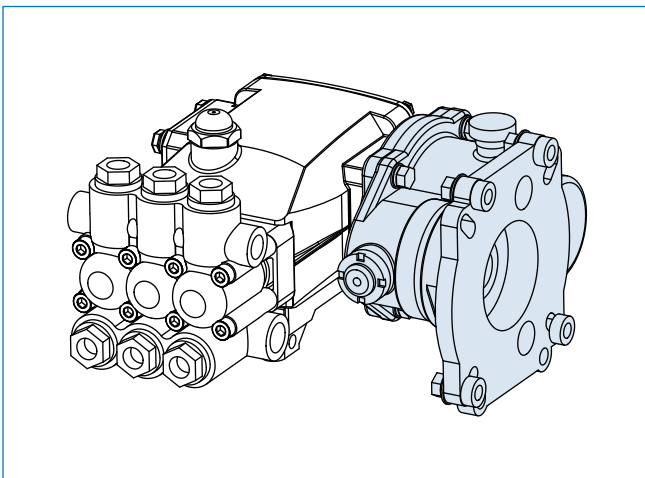

Gearbox

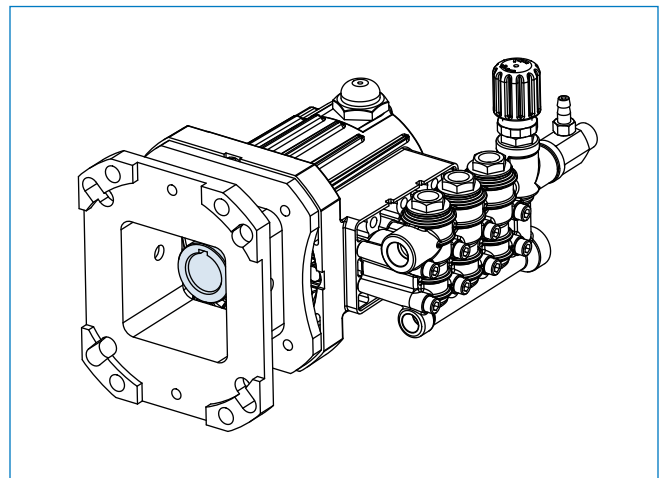

Hollow Shaft Mount

Be the best-in class and realize low life cycle costs —

Choose pumps and accessories from Cat Pumps!

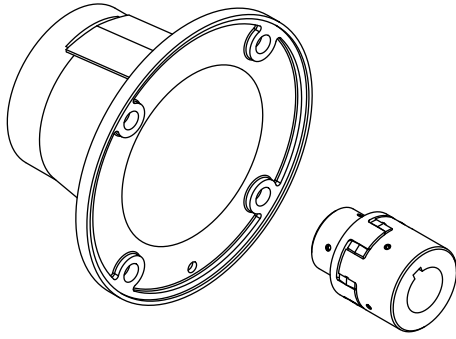

Bell Housing and Flexible Coupling

Compact direct mounting to electric motors reduces space requirements.

- Coupling assembly includes metric and standard coupler halves, spider and keys.
- Special urethane flexible spider designed for extended life with high temperature and high RPM

MOTOR FRAME	PART NUMBER	PUMP MODELS
-------------	-------------	-------------

BELL HOUSING

56C, 143-145TC	34121	230-277
56C, 143-145TC	34422	3CP1120-1140, 3CP1221-1241
143-145TC	35421	5CP2140WCS-2150W, 5CP6241CS-6251
182-184TC	34126	230-277
182-184TC, 213-215TC*	34131	340-357
182-184TC, 213-215TC*	34423	3CP1120-1140, 3CP1221-1241
182-184TC, 213-215TC*	34424	5CP2140WCS-2150W, 5CP6241CS-6251
182-184TC, 213-215TC, 254-256TC*	31570	7CP6110-6171

Note: * Adapter kit PN 990213 must be used to convert motor frame to 213-215TC or 254-256TC

SHAFT TO SHAFT DIMENSIONS	PART NO.	MOTOR FRAME	PUMP MODELS
---------------------------	----------	-------------	-------------

FLEXIBLE COUPLING

M16.5 x 5/8"	8215	56C	230-277, 3CP1120-1140, 3CP1221-1241
M16.5 x 7/8"	8210	143-145TC	230-277, 3CP1120-1140, 3CP1221-1241
M16.5 x 1 1/8"	8220	182-184TC	230-277, 3CP1120-1140, 3CP1221-1241
M16.5 x 1 1/8"	8225	182-184TC	230-277, 3CP1120-1140, 3CP1221-1241
M16.5 x 1 3/8"	8270	213-215TC	230-277, 3CP1120-1140, 3CP1221-1241
M20 x 7/8"	8260	143-145TC	340-357, 5CP2140WCS-2150W, 5CP6241CS-6251
M20 x 1 1/8"	8230	182-184TC	340-357, 5CP2140WCS-2150W, 5CP6241CS-6251
M20 x 1 3/8"	8275	213-215TC	340-357, 5CP2140WCS-2150W, 5CP6241CS-6251
M24 x 1 1/8"	8370	182-184TC	7CP6110-7CP6171
M24 x 1 3/8"	8375	213-215TC	7CP6110-7CP6171
M24 x 1 5/8"	8380	254-256TC	7CP6110-7CP6171

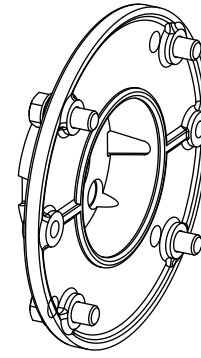

Motorized Flange Mount

Completely assembled unit with pump, flange mount and motor for use in limited space requirements.

- Eliminate assembly time and multiple sourcing.
- All motors are 60HZ Contact Cat Pumps for 50HZ motor options.

PUMP MODELS	FLANGE PART NO.	MOTOR PART NO. / SPECS	MOTORIZED PUMP UNITS
-------------	-----------------	------------------------	----------------------

STANDARD PLUNGER PUMPS

230, 231, 237	8020	8023ES - 1.5HP/1PH	230BD151, 231BD151, 237BD151
230 - 277	8021	8024ES - 3.0HP/1PH	230BD31, 231BD31, 237BD31, 240BD31, 241BD31, 247BD31, 270BD31, 271BD31, 277BD31
230 - 277	8021	8025ES - 3.0HP/3PH	230BD33, 231BD33, 237BD33, 240BD33, 241BD33, 247BD33, 270BD33, 271BD33, 277BD33
	8022	8026ES - 3.0HP/1PH	340BD31, 341BD31, 347BD31, 350BD31, 351BD31, 357BD31
340, 340B, 340S, 341, 347, 350, 350B, 350S, 351, 357	8022	8027ES - 3.0HP/3PH	340BD33, 341BD33, 347BD33, 350BD33, 351BD33, 357BD33
	8022	8028ES - 5.0HP/1PH	340BD51, 341BD51, 347BD51, 350BD51, 351BD51, 357BD51
	8022	8029ES - 5.0HP/3PH	340BD53, 341BD53, 347BD53, 350BD53, 351BD53, 357BD53

CP SERIES PLUNGER PUMPS

3CP1130, 3CP1231	8001	8023ES - 1.5HP/1PH	3CP1130BD151, 3CP1231BD151
	8002	8024ES - 3.0HP/1PH	3CP1120BD31, 3CP1130BD31, 3CP1140BD31, 3CP1221BD31, 3CP1241BD31
3CP1120-1140, 3CP1221, 1241	8002	8025ES - 3.0HP/3PH	3CP1120BD33, 3CP1130BD33, 3CP1140BD33, 3CP1221BD33, 3CP1241BD33
3CP1120, 1130, 1140	8002	8038ES - 6.0HP/1PH	3CP1120BD63, 3CP1130BD63, 3CP1140BD63
	8002	8041ES - 6.0HP/1PH	3CP1120BD61, 3CP1130BD61, 3CP1140BD61
	8003	8026ES - 3.0HP/1PH	5CP2140WBD31, 5CP2150WBD31, 5CP6251BD31
5CP2140WCS, 5CP2150W, 5CP6251	8003	8027ES - 3.0HP/3PH	5CP2140WBD33, 5CP2150WBD33, 5CP6251BD33
	8003	8028ES - 5.0HP/1PH	5CP2140WBD51, 5CP2150WBD51, 5CP6251BD51
	8003	8029ES - 5.0HP/3PH	5CP2140WBD53, 5CP2150WBD53, 5CP6251BD53
5CP2140WCS, 5CP2150W	8003	8040ES - 6.0HP/3PH	5CP2140WBD63, 5CP2150WBD63
	8003	8042ES - 6.0HP/1PH	5CP2140WBD61, 5CP2150WBD61

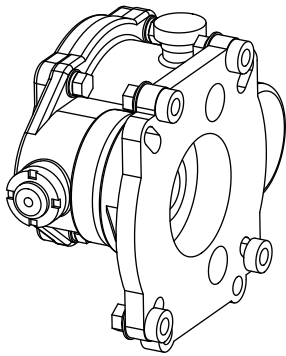

Gearboxes

Easily mounts directly to a standard 1" gas engine without need for pulleys and belts.

- Retrofit an existing pump with gearbox.
- Pump models with gearboxes available as noted.

MODEL	PUMP MODELS
8051	51G1, 58G1
8061	34G1, 35G1
8065	45G1
8071	56G1, 59G1, 60G1, 70G1
8075	3CP1120G, 3CP1211G
8076	5CP3120CSSG1, 5150G1, 5CP6120CSSG1, 6190G1
8081	7CP6110G1, 7CP6111G1
8086	5CP5140CSSG1

Note: G1 = 1" Gearbox

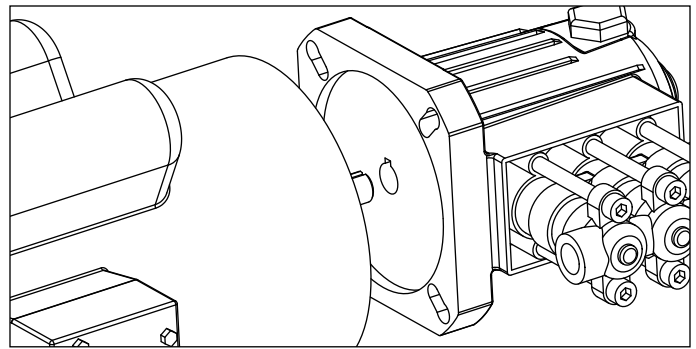

Hollow Shaft Pumps

Ultra-compact, hollow shafted pumps easily mounts directly to electric motor or gas engine.

- Mounting hardware included with all electric and gas pump models.
- Gas adapter plates included with gas model pumps.

SHAFT DIAMETER	MOTOR FACE	PUMP MODELS
ELECTRIC MOTOR DRIVEN		
1/2"	Contact Cat Pumps	1CX013ELS.MIST, 1CX025ELS.MIST, 1CX05ELS.MIST
5/8"	56C	2DX20ES, 2DX05ELS.MIST, 2DX15ES.MIST, 2DX20ES.MIST, 2DX27ES.MIST, 2DX30ES.MIST, 2SF10ES, 2SF20ES, 2SF22ELS, 2SF22ES, 2SF29ELS, 2SF30ES, 2 SF35ES, 2SF05SEEL, 2SF10SEEL, 2SF15SEEL, 2SF22SEEL, 2SF25SEEL, 2SF29SEEL, 2SF35SEEL, 2SF42SEEL, 2SFX20ES, 2SFX22ES, 2SFX30ES
3/4"	56C	2SF30GES, 2SF35GES, 2SFX30GES, 3SPX35GEI
1 1/8"	184TC/215TCZ	4SF40ELS, 4SF45ELS, 4SF50ELS

SHAFT DIAMETER	MOUNTING FLANGE	PUMP MODELS
GAS ENGINE DRIVEN		
3/4"	SAE J609*	2DX30GS, 2SF30GS, 2SF35GS, 2SFX30GS, 2SFX30GZ, 3DNX25GSI, 3DNX27GSI, 3DX29GSI, 3DX30GSI
1"	SAE J609**	3SPX30G1I, 4SF35GS1, 4SF40GS1, 4SF45GS1, 4SF50GS1, 66DX30G1I, 66DX35G1I, 66DX40G1I

Note: * Flange A, Extension 3, Shaft Length-2.296, Pilot-1.625 diameter, Bolt Center-3.625 diameter
 Note: ** Flange B, Extension 4, Shaft Length-3.250, Pilot-5.750 diameter, Bolt Center-6.500 diameter

Keys

Provides alignment and secures pump shaft to motor shaft to prevent turning.

- Keys supplied with Cat Pumps.
- Keys supplied with gearboxes and flexible couplings.

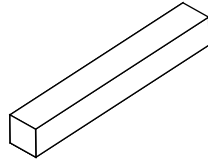

PART NUMBER	SIZE (MM) UNLESS AS NOTED	PUMP MODELS
30050	3/16" x 3/16" x 1 1/4"	2SF Electric, Gas and Stainless Steel Series
30088	1/4" x 1/4" x 1 3/8"	Flexible Couplings: 8220, 8225, 8230
34050*	3/16" x 3/16" x 27mm	2DX.MIST, 2DX20ES, 2DX30GS, 3DNX25GSI/27GSI, 3DX29GSI/30GSI
44294	3/16" x 3/16" x 1 3/4"	Gearboxes (engine side): 8010, 8075
44455	1/4" x 1/4" x 2 5/32"	4SF Gas Series, Gearboxes (engine side): 8051, 8061, 8065, 8068, 8071, 8076, 8077, 8078, 8081
44459	8 x 7 x 24	Gearboxes (pump side): 8051, 8071, 8078
45217**	1/4" x 1/4" x 64mm	3SPX30G11, 66DX30G11/35G11/40G11
46076*	1/4" x 1/4" x 2 1/2" Tapered	4SF Electric Series
49411	1/4" x 1/4" x 59mm	67DX39G11
57352	5 x 5 x 21	Gearboxes (pump side): 8010, 8075
76059*	1/8" x 1/8" x 1 1/2"	1CX Electric Series
101814	6 x 6 x 27	Gearboxes (pump side): 8061, 8065, 8068, 8076, 8077, 8081
547162	3/16" x 3/16" x 1 1/2"	3SPX35GEI
831844**	1/4" x 1/4" x 56mm	3SPX30G11

Note: * Hardened ** Surface Hardened

Lubricants

Crankcase oil, gearlube, anti-seize and sealant products to ensure proper operation and lubrication of pump.

- Custom blend, premium grade, petroleum-based hydraulic oil for all Cat Pumps.
- Gearlube provides anti-wear, anti-rust and anti-corrosion protection prolonging gearbox life.

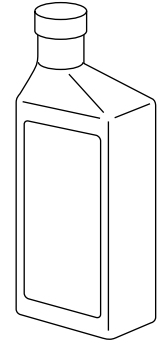

PART NUMBER	CAPACITY	PUMP MODELS
-------------	----------	-------------

OIL

6100	Case - 12-21 ounce bottles	All plunger pumps
6105	Twin pack - 2 x 2.5 gallons	All plunger pumps
6107	Bottle - 21 ounces	All plunger pumps
6109	Drum - 30 gallons	All plunger pumps

GEARLUBE

6110	Bottle - 16 ounces	34-35G1, 45G1, 51-70G1, 3CP1120G, 5CP3120G1, 5140G1, 5150G1, 6120G1, 6190G1, 7CP6110G1, 6111G1
6111	Case, 12-16 ounce bottles	

ANTI-SEIZE AND SEALANTS

6106	2 milliliters	Anti-seize for pump shafts and keys - all plunger pumps
6119	2 ounces	Anti-seize for threads - all stainless steel plunger pumps
6124	3 ounces	Liquid gasket for o-rings, seals - all plunger pumps

Total Life Cycle Cost:

More and more users of pumping systems are making purchase decisions based on a systems Total Life Cycle Cost and not based on the systems initial cost. Pump, installation, energy use, downtime, operating expense and maintenance are all factors considered to determine a systems overall life cycle cost. The objective of life cycle costing is to evaluate and optimize product life costs yet satisfying the performance, safety, reliability, and maintainability of the system.

Cat Pumps is keenly aware of minimizing life cycle costs in both its pump and accessory component designs. A pumping systems ongoing performance is as good as its weakest component, that's why we rigorously test and evaluate our accessory components. Our mission is to provide the best system value by providing pumps and accessories that exceed your performance and reliability expectations so you can realize the lowest possible life cycle cost.



CAT PUMPS

1681 - 94TH LANE N.E. MINNEAPOLIS, MN 55449-4324
 PHONE (763) 780-5440 — FAX (763) 780-2958
 e-mail: techsupport@catpumps.com
 www.catpumps.com