

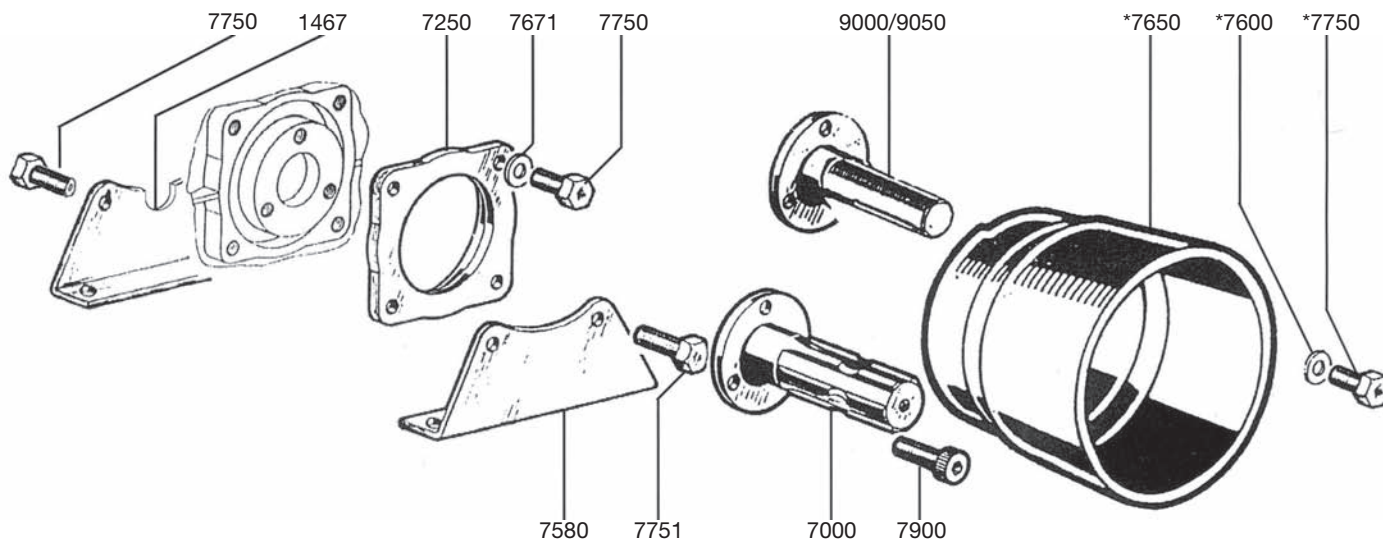

# 7702.01 Male PTO Shaft Kit

## 7751.A1 1" Solid Shaft Kit

**7702.01 & 7751.A1**

REF#	PART#	DESCRIPTION	QTY	REF#	PART#	DESCRIPTION	QTY
1467	1202.47	Base Plate with Notch	1	7671	1403.09	Washer	2
7000	7753.A6	1-3/8" Male PTO Shaft	1	*7750	1804.06	Hex Bolt	4
7250	0501.02	Seal Retainer Flange	1	7751	1804.07	Hex Bolt	2
7580	1202.02	Base Plate	1	7900	1805.04	Allen Bolt	3
*7600	1403.36	Washer	2	9000	7751.A3	1" Solid Shaft	1
*7650	1219.02	PTO Safety shield	1	9050	7750.31	3/4" Solid Shaft	1

\* Standard with Kit #7702.01. Optional with Kit #7751.A1.

### INSTALLATION INSTRUCTIONS

#### NOTE - USE BLUE THREADLOCKER 242 OR EQUIVALENT ON ALL BOLTS.

1. Attach the shaft to the pump crankshaft using the (3) allen bolts (Ref. #7900).
2. Bolt the NOTCHED base plate (Ref. #1467) to the non-drive side of the pump with (2) hex bolts (Ref. #7750).
3. Position seal retainer flange (Ref. #7250) onto pump mounting flange and install remaining base plate (Ref. #7580) to pump using (2) hex bolts (Ref. #7751).
  - A. For 7751.A1 1" male shaft kit, install remaining (2) hex bolts (Ref. #7750) and (2) washers (Ref. #7671) into seal retainer flange.
  - B. For 7702.01 male PTO shaft kit, install PTO safety shield (Ref. #7650) to face of seal retainer flange and then follow Step A.
4. Pump and base assembly must be secured and aligned properly to prevent movement.
5. If 1" solid shaft kit (Part #7751.A1) is to be driven by a telescopic drive shaft, PTO safety shield (Ref. #7650) must be installed to pump.

**NOTE:** Adequate protection must be provided in guarding around ALL moving parts, including belts, shafts, pulleys, and drive couplers.